

NOVUM

Redefining refrigeration

DUBLINER Technical Specifications



DUBLINER

The Dubliner Walkaround freezer is continuously used by the #1 food retailer in the USA. The Dubliner has been designed to meet the exacting needs of the modern retailer in terms of energy efficiency, product visibility, reliability and making efficient and efficient use of available floorspace.

This highly customisable and easily merchandised cabinet will not only enhance the image of your store but will lead to higher product sales through enhancing the shopping experience for your customers.



**DOE
approved**

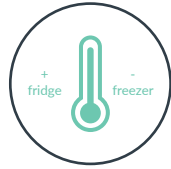

**Universal
Freezer &
Chiller**



**Lower
Energy Bills**

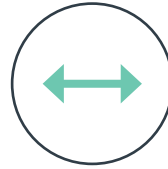

**Sliding Lids
Save on
Energy**



**Ultra Low
Maintenance**



DUBLINER

is designed for retailers who want an attractive cabinet at a reasonable price without compromising on the product integrity, visibility or energy consumption. The Dubliner's distinctive sliding curved glass lid will not only increase the visibility of your product but will greatly add to the effectiveness of your in-store spot promotions.

Technical Specification

Dubliner	Model	710L Dubliner
Technical Data		
Gross content	cu. ft.	26
Net Content according to AHAM	cu. ft.	20.5
Total Display Area (TDA)	sq. ft.	11.3
Classification according to EN 23953		3L1
Ambient Temperature Range	°F	+61 to +77
Inner Temperature Range	°F	0 to -13
Sound Pressure at 1m Distance	dB(A)	43.3
Electrical Data		
Nominal Voltage / Frequency	V / Hz	110-120 / 60
Nominal Power Cabinet	w	400
Nominal Power LED Light	w	24
Nominal Current	A	6
Fuse Protection	A	20
Energy consumption (at 77°F)	kWh/24h	5.6
Length of Power Supply Cord	inches	78.7
Refrigeration Data		
Refrigerant	Type	R290
Gas Charge	oz	4
Maximum Operating Pressure	PSI	435
Maximum Heat Output	W/h (Btu/h)	616 (2100)
Dimensions		
Length Outside/ Inside	inches	77.25/69.5
Depth Outside/ Inside	inches	33.9 / 31
Front Access Height Outside / Inside	inches	34.5 / 23.10
Stacking Height at the Front / Back	inches	24 / 23.6
Weight		
Net Weight (excl. packaging, incl. internal accessories)	lbs	335
Gross Weight (incl. packaging & internal accessories)	lbs	408

Dubliner Dimensions

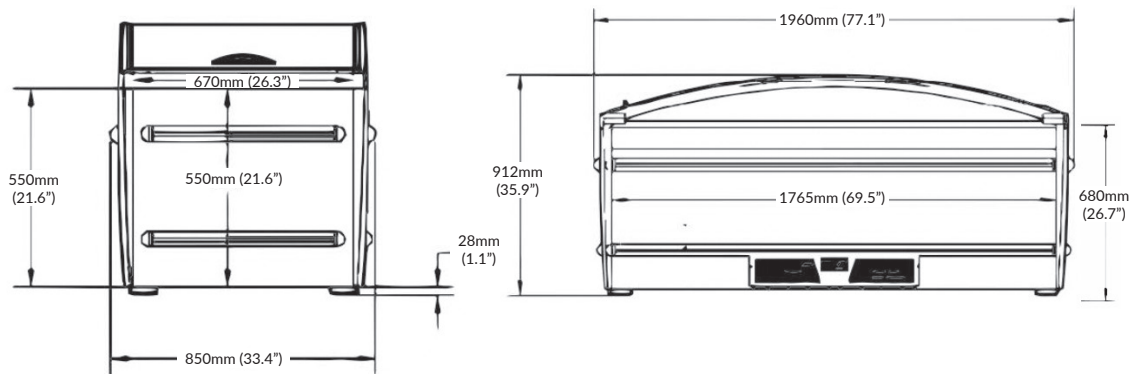

Novum USA

7405 Graham Road
Suite B
Fairburn
GA 30213
Phone: (678) 787-0755

www.novumusa.com

NOVUM
Redefining refrigeration

